

**John R. Guminak
Drafting & Design
Services**
West Dover, Vt.
For
**Treehouse
Timber Frame &
Log Homes**
W. Wardsboro, Vt.

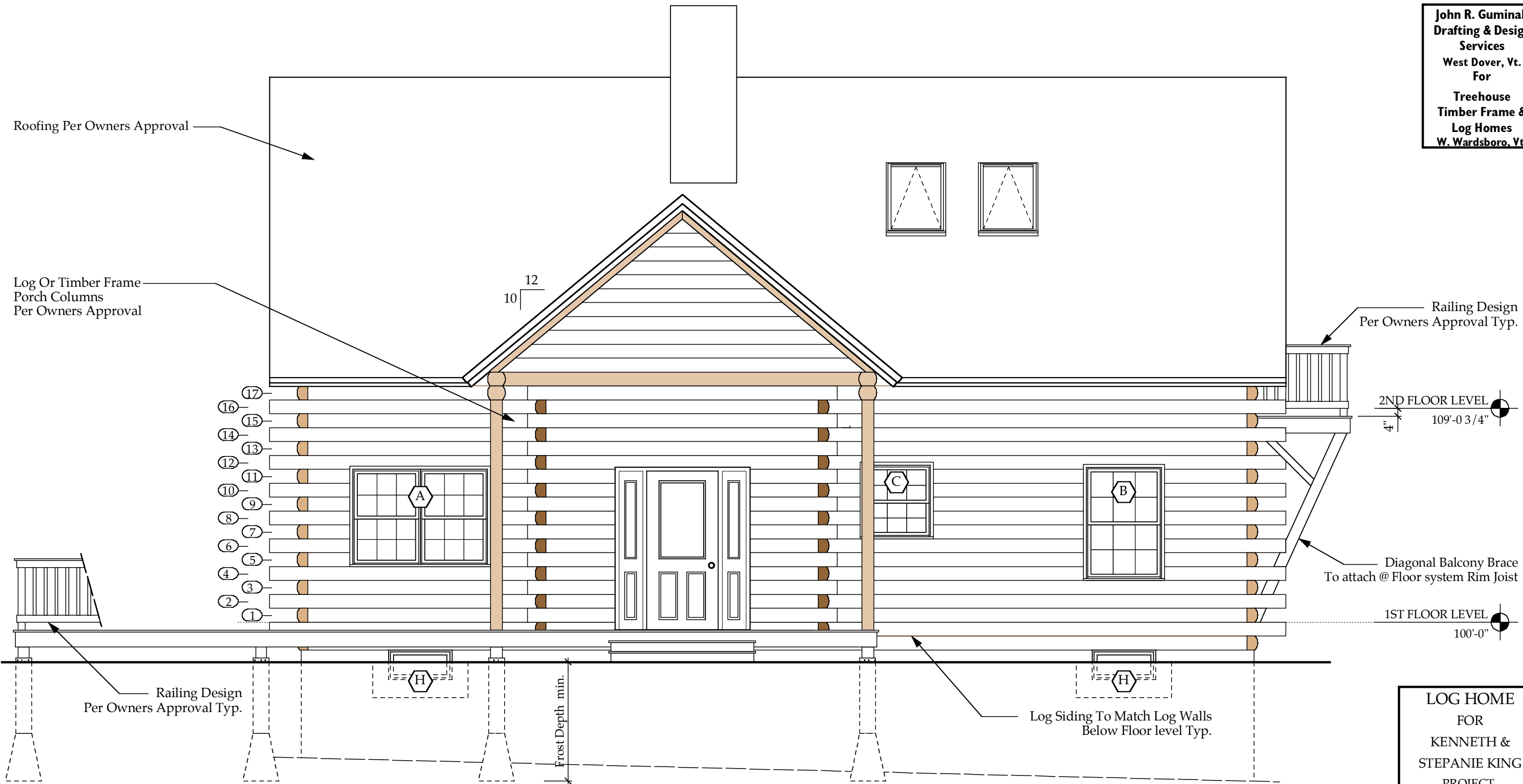

WINDOW SCHEDULE (Lincoln Windows)					
#	Type	Model #	R.O. (W)	R.O. (H)	Qty
A	Double Hung	CDH2-2820	5' - 7 5/16"	4' - 1"	3
B	Egress Dbl Hung	CDH1-3224	3' - 1 7/8"	4' - 9"	4
C	Double Hung	CDH1-2814	2' - 9 7/8"	3' - 1"	1
D	Casement	CC2-2028	4' - 2 11/16"	2' - 9 9/16"	1
E	Fixed	VIF	2' - 4"	5' - 6"	2
F	Fixed	VIF	2' - 6"	7' - 6"	2
G	Fixed	VIF	2' - 2"	3' - 6"	2
H	Basement Utility	VIF	3'-0" +/- VIF	1'-6" +/- VIF	5

Window Notes:

1. Model #'s and Rough Openings as listed are for "Lincoln Windows" Alternate window Manufacturers may be substituted upon owners approval.
2. Egress windows as listed in schedule must meet the minimum clear opening requirements of 20" wide and 5.7 sq.ft.
3. GC to verify all window options (Glazing, Grilles, Color, Trim, ect.) with Owner.

FRONT ELEVATION

**LOG HOME
FOR
KENNETH &
STEPANIE KING
PROJECT**

9903
PROJECT #

8/10/00
DATE

1/4" = 1'-0"
SCALE

FRONT ELEVATION

A2.1
SHEET